

Stage1: Separate the inner rail from outer rail

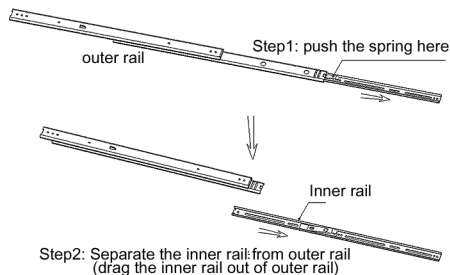

Stage2: Install the inner rail with two sides of chassis first

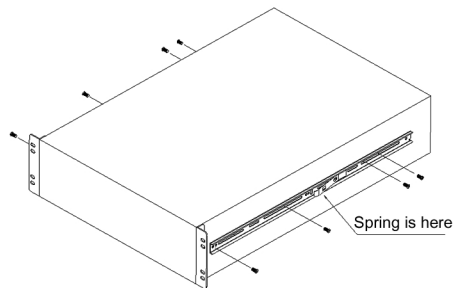

Stage3: Outer rail assembly

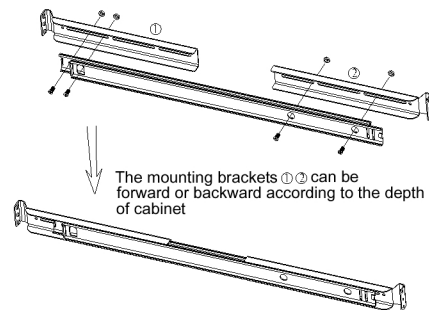

Stage4: Outer rail installed with cabinet in advance

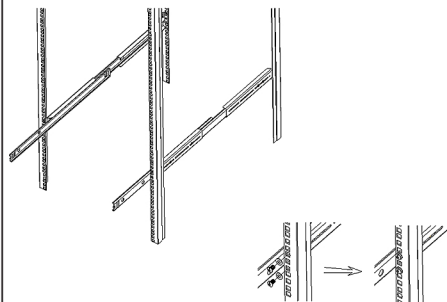

Stage5: Push in the chassis (inner rail installed) to the cabinet

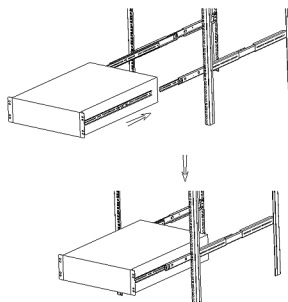

Stage6: Stacked brackets (standard part) for some 2U/4U cases

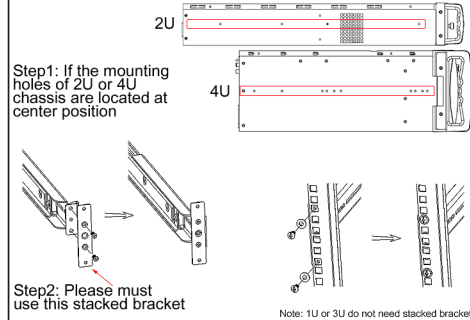

Military-Class Slide Rail for 1U 2U 3U 4U chassis
Durable for 65 KGM (143 pounds/lbs)

容許公差:
TOLERANCES:

XXX ± 0.25
XX ± 1.00
X ± 2.50

投影法:
PROJECTION:

第三角法

材料規格:
MATERIAL:

核准者: Robert Roan

審核者: Jun Chen

繪圖者: Randy Lee

日期: April 24, 2012

日期: April 13, 2012

日期: April 12, 2012

品名:
NAME:

Military-Class
Slide Rail Installation Guidance

料號:
PART NO:

圖號:
DRAW NO:

單位: mm

規格: 0.0

版次: 0.0

REV. NO:

槽號:
FILE NO:

編號: 0.0

編號: 0.0

規格: 0.0

規格: 0.0

規格: 0.0